

Description

- ▲ The VCL provides a sturdy means of access to areas only accessible through a vertical door/loft hatch or onto a mezzanine floor.
- ▲ The ladder is designed to cater for a maximum floor to floor height of 3210mm.
- ▲ The VCL incorporates a Youngman Deluxe 2 section Aluminium sliding loft ladder (*pictured right*) together with a running/carriage board.
- ▲ The special tracked carriage board mounted on nylon rollers enable the unit (in its stored position) to roll quietly clear of the floor's edge.
- ▲ The ladder is constructed from high strength extruded aluminium.
- ▲ The VCL's spring counterbalanced system allows for a safe and smooth deployment of the ladder.
- ▲ The VCL comes supplied with two metal handrails as standard.
- ▲ The unit comes complete with all necessary fittings and operating pole.

N.B. The VCL does not come supplied with a Vertical trapdoor/hatch.

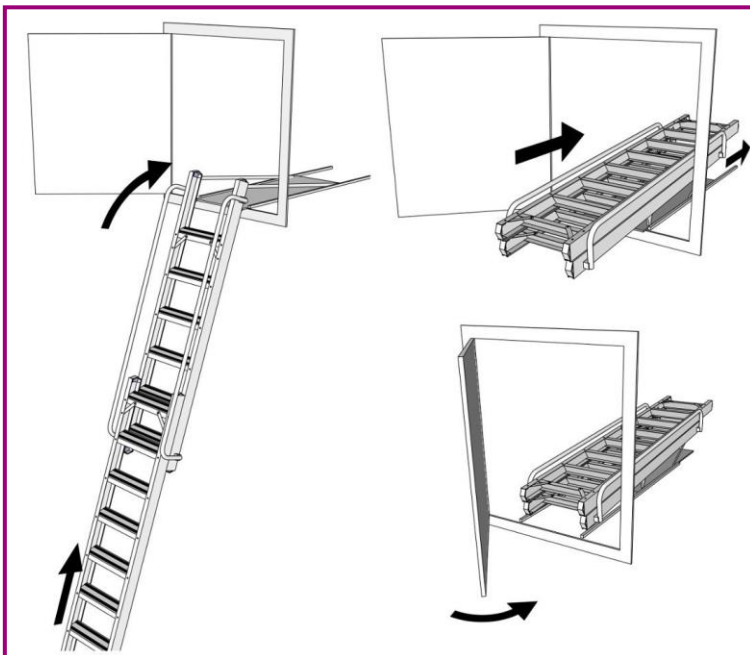

Dimensions

- ▲ Recommended Minimum Opening Size – 900mm x 600mm.
- ▲ Minimum Storage Height – 1070mm.
- ▲ Minimum Storage Length – 2250mm.
- ▲ Ladder Width – 402mm.
- ▲ Tread Width – 330mm.
- ▲ Tread Depth – 74mm.